



Maillard
& Co.

£ 340,000

Victoria Street

For Sale



“Modern, one bedroom apartment with outside terrace.”

1

Bedrooms

1

Receptions

1

Bathrooms

For Sale

Property features

Modern one bedroom	408 sqft
Outside terrace	Fully integrated modern kitchen
Low service charge £122pcm	Central location
Spacious living	Share Transfer



Property details

Modern, one bedroom apartment with outside terrace.

We are delighted to present to market this, first floor, one bedroom apartment. Located on the outskirts of town and just a short stroll to all local amenities. The building was completely refurbished in 2021. This stunning property is offered in walk in-condition, briefly comprises, bright, spacious, living room with a work from home area, separate modern integrated kitchen, large double bedroom with separate dressing area and built in cupboards, modern shower room and a spacious sunny enclosed terrace.

Residents parking scheme available in the area.

Sold with vacant possession and no onward chain.

Service charge £122 per month to include building insurance, communal lighting and cleaning, contribution to sinking fund.

Disclaimer

Please call Maillard & Co on 880 880. Please note that all areas and measurements given in these particulars are approximate and rounded. The text, photographs and floor plans are for general guidance only.

Once an offer is accepted and negotiations for the purchase of a property are entered into, the prospective purchasers will be asked to produce photographic identification (passport or driving licence) and proof of residency documentation eg, a current utility bill together with confirmation of source of funds. This is in order for us to comply with the current Money Laundering Legislation.













GROUND FLOOR
408 sq.ft. (37.9 sq.m.) approx.

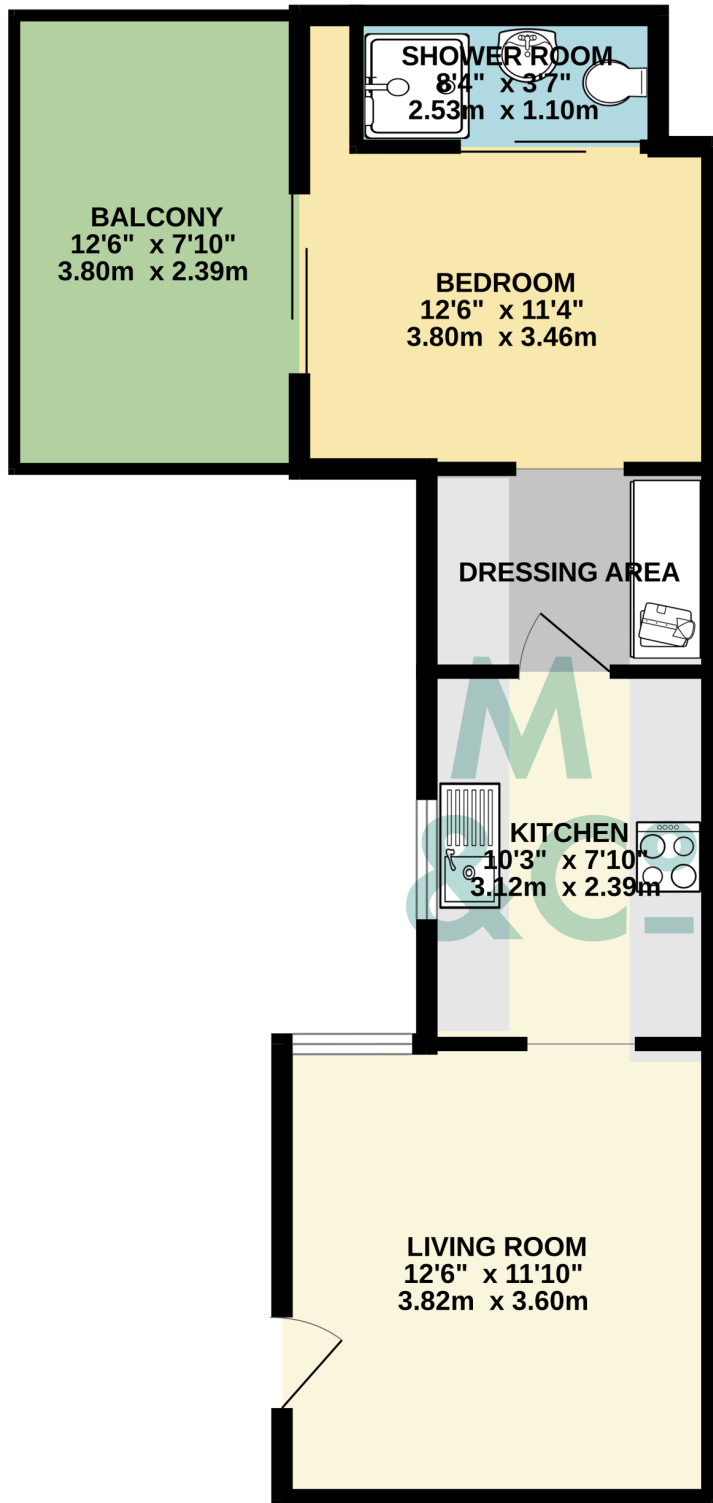

TOTAL FLOOR AREA : 408 sq.ft. (37.9 sq.m.) approx.

Whilst every attempt has been made to ensure the accuracy of the floorplan contained here, measurements of doors, windows, rooms and any other items are approximate and no responsibility is taken for any error, omission or mis-statement. This plan is for illustrative purposes only and should be used as such by any prospective purchaser. The services, systems and appliances shown have not been tested and no guarantee as to their operability or efficiency can be given.

Made with Metropix ©2023

JERSEY ESTATE AGENTS' ASSOCIATION

PROTECTED

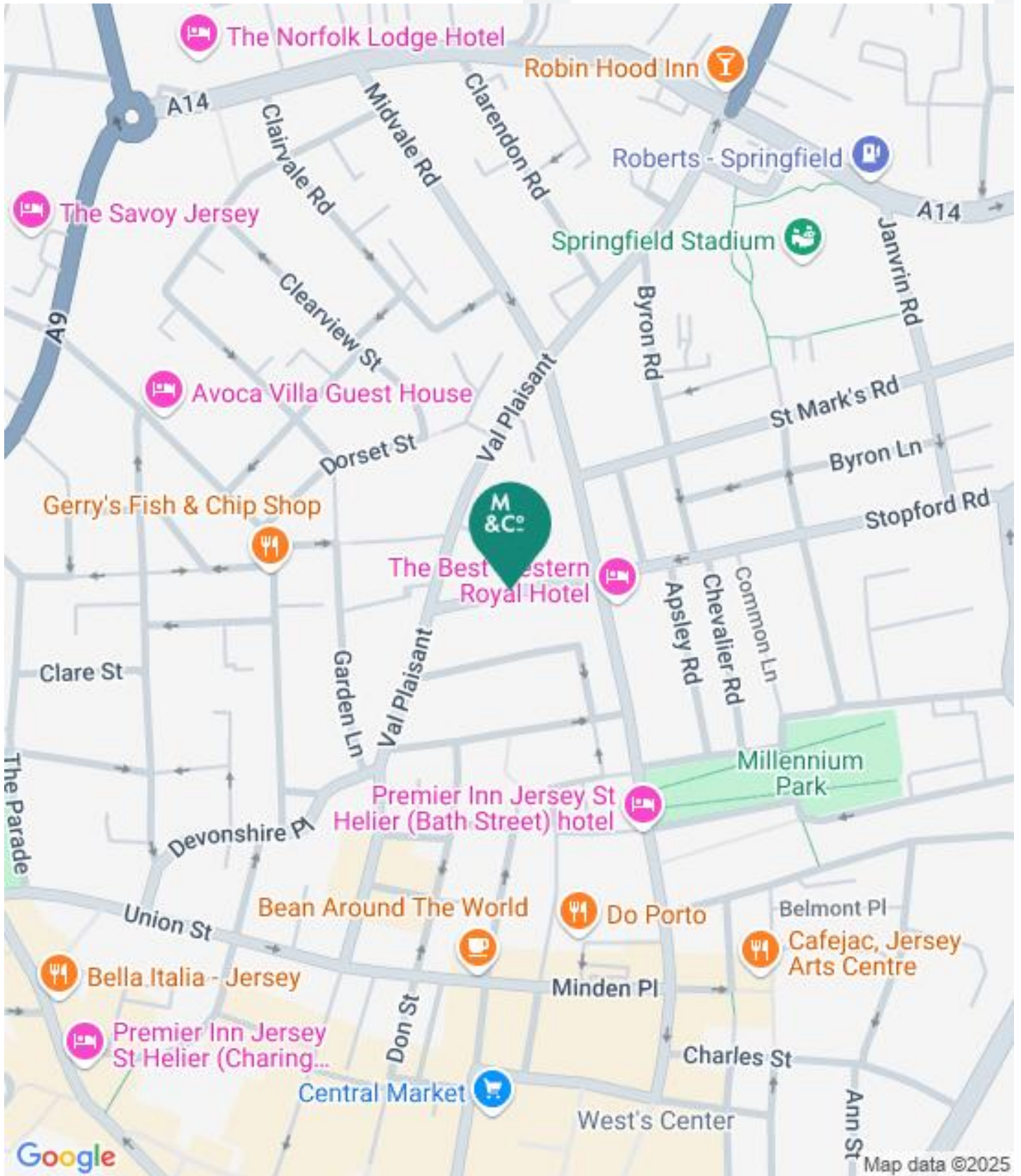



Bradley Rolland

Head of Sales

brolland@maillardandco.com

01534 883184



Bridie Newsham

Sales Consultant

bnewsham@maillardandco.com

01534 883103