



Maillard
& Co

£ 475,000

Nelson Street

For Sale



“Spacious Purpose Built Apartment with
Designated Parking”

2

Bedrooms

1

Receptions

1

Bathrooms

For Sale

Property features

Purpose Built	Designated Parking
Large Living Room-Diner	Fantastic Storage



Property details

This bright and spacious purpose built apartment shares the block with just 5 other units and is conveniently located on the outskirts of the town centre within just a five minute walk to the high street.

A large entrance hall welcomes you into the home with a guest W.C and plenty of built in cupboards providing excellent storage. There is an additional rear entrance which is only used by one other occupant and the present owner is able to securely keep a bicycle on the ground floor.

Offering two generous double bedrooms, the apartment features a very generous living room with an allocated area for a large dining table for entertaining. The separate kitchen is fully fitted and the shower room is spacious and modern.

Designated parking for one car and a public car park very close by for visitors.

Mains drains and water. Pets welcome. Service charge £224 per month to include property management. Share Transfer.

Spacious Purpose Built Apartment with Designated Parking

Disclaimer

Please call Maillard & Co on 880 880. Please note that all areas and measurements given in these particulars are approximate and rounded. The text, photographs and floor plans are for general guidance only.

Once an offer is accepted and negotiations for the purchase of a property are entered into, the prospective purchasers will be asked to produce photographic identification (passport or driving licence) and proof of residency documentation eg, a current utility bill together with confirmation of source of funds. This is in order for us to comply with the current Money Laundering Legislation.

















FIRST FLOOR
817 sq.ft. (75.9 sq.m.) approx.

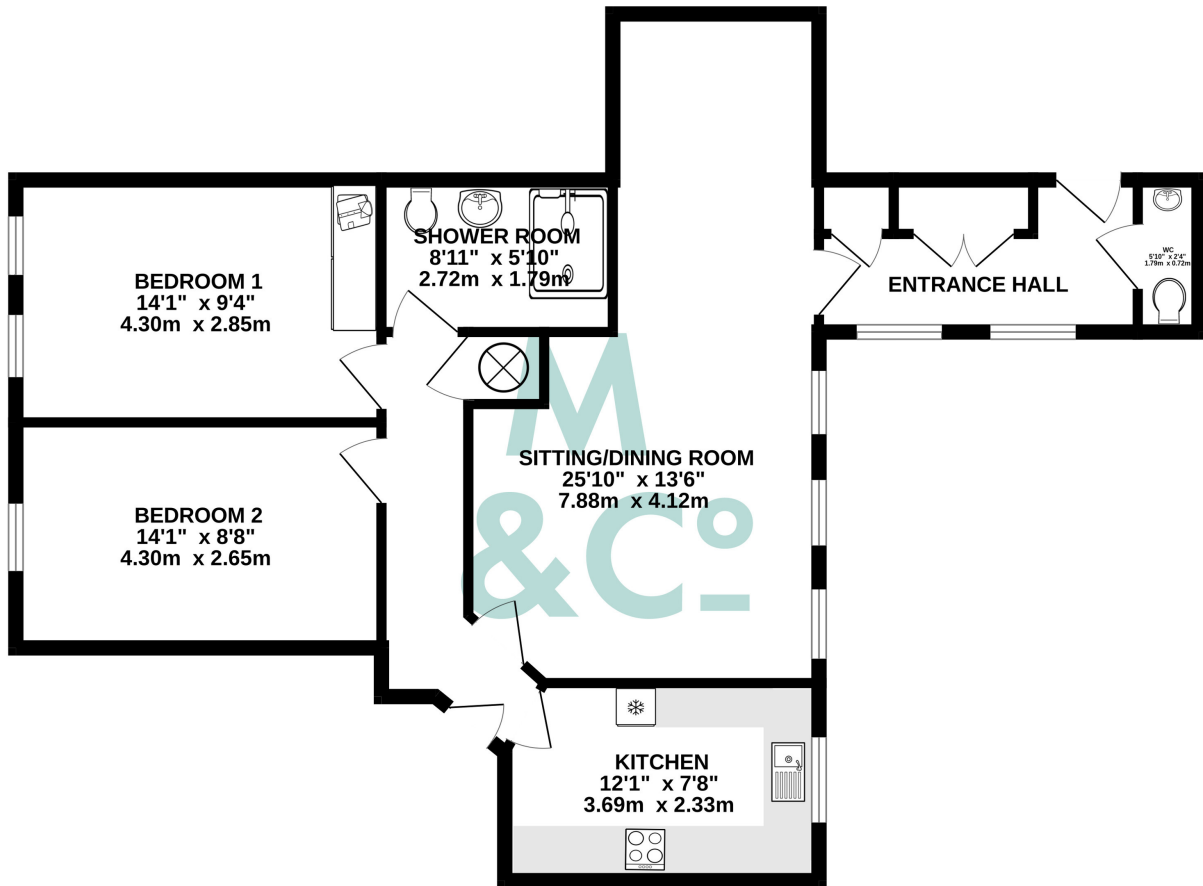

TOTAL FLOOR AREA : 817 sq.ft. (75.9 sq.m.) approx.

Whilst every attempt has been made to ensure the accuracy of the floorplan contained here, measurements of doors, windows, rooms and any other items are approximate and no responsibility is taken for any error, omission or mis-statement. This plan is for illustrative purposes only and should be used as such by any prospective purchaser. The services, systems and appliances shown have not been tested and no guarantee as to their operability or efficiency can be given.
Made with Metropix ©2024

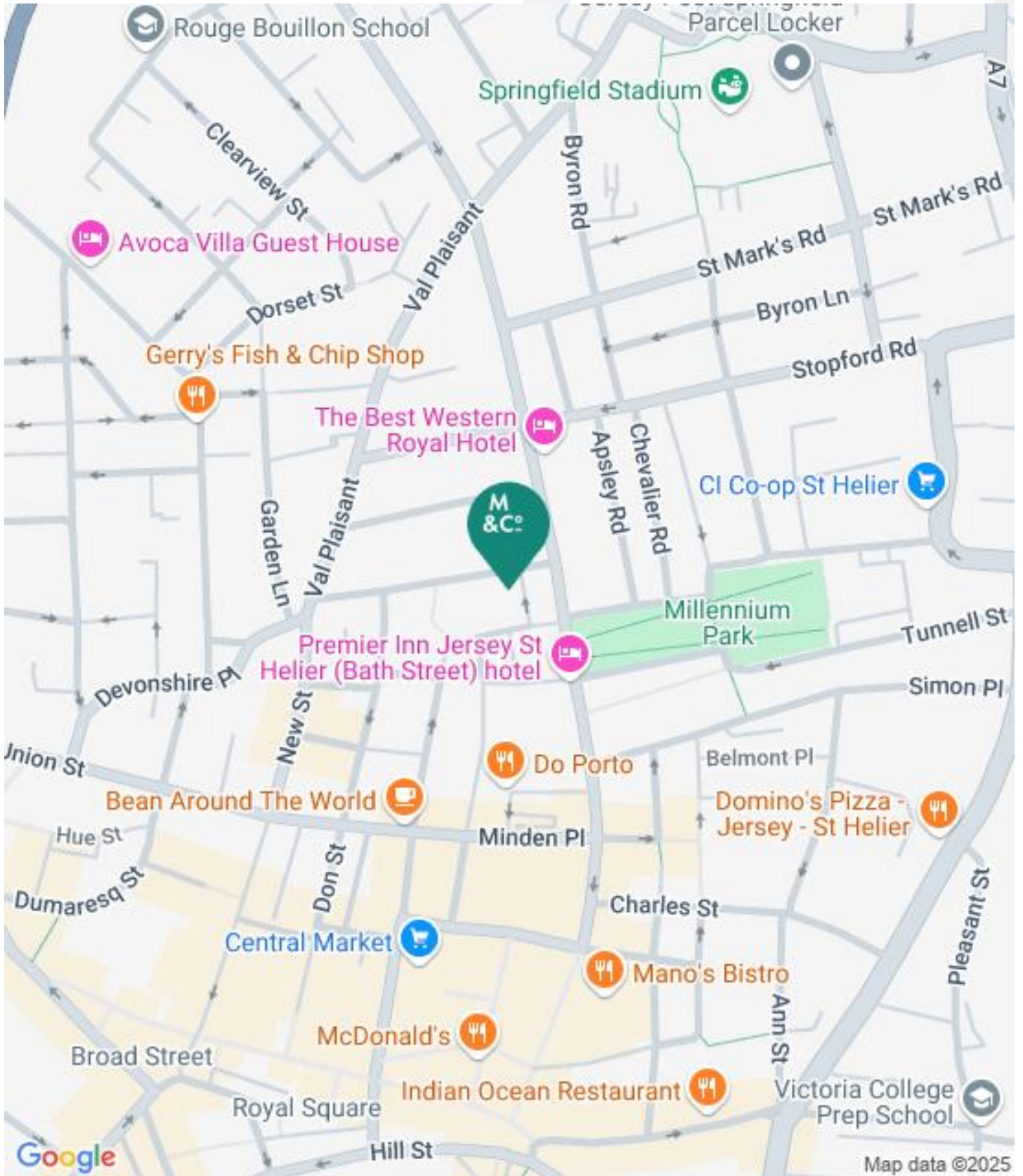



Bradley Rolland

Head of Sales

brolland@maillardandco.com

01534 883184



Bridie Newsham

Sales Consultant

bnewsham@maillardandco.com

01534 883103